

Urgent Return receipt Expand Group Restricted Prevent Copy

Esther Hiu Laam LI/PLAND

寄件者: pang hingyeun [REDACTED]
寄件日期: 2026年06月09日星期二 23:59
收件者: Esther Hiu Laam LI/PLAND
主旨: 回覆: Planning Application No. A/NE-FTA/277- Proposed Temporary Warehouse for Storage of Construction Materials with Ancillary Office and Associated Filling of Land for a Period of 3 Years
附件: A_NE-FTA_277.pdf; ROP.pdf
類別: Internet Email

Dear Ms. Li,

We responded to the TD's comments.
Thank You !

Regards,
H.Y.Pang

從 [Outlook](#) 傳送

Planning Application No. A/NE-FTA/277

1. The stretch in question is not busy, nor is it a main thoroughfare. Moreover, because the land near the application site has been requisitioned by the government, many users have relocated, resulting in a significant reduction in vehicle traffic. At present, the main users of this road segment are the nearby logistics center. During the morning peak hours from 7:00 a.m. to 9:00 a.m., there are approximately 8–10 vehicle entries and exits per day. During the evening period from 5:00 p.m. to 7:00 p.m., there are approximately 6–8 vehicle entries and exits per day. Outside these time windows, the average is about four vehicle movements (entries and exits combined) every two hours.
2. Please refer to the attached routing plan. The vehicle dimensions show in (ROP1) are for light goods vehicle (5.2 m length and 1.8 m width). The vehicle dimensions show in (ROP2) are for private car (4.5 m length and 1.8 m width).
3. We will place warning signs at the entrances to remind road users to pay attention to vehicle entry and exit and pedestrian safety.
4. We will assign staff to manage vehicle entry and exit issues, ensure no queuing of vehicles outside the site.
5. We will install signage to remind vehicles that parking in illegal locations is prohibited. We will also install cameras to monitor parking conditions, and if illegal parking is detected, we will immediately dispatch staff to address the issue.
6. We will seek comments from the responsible party.

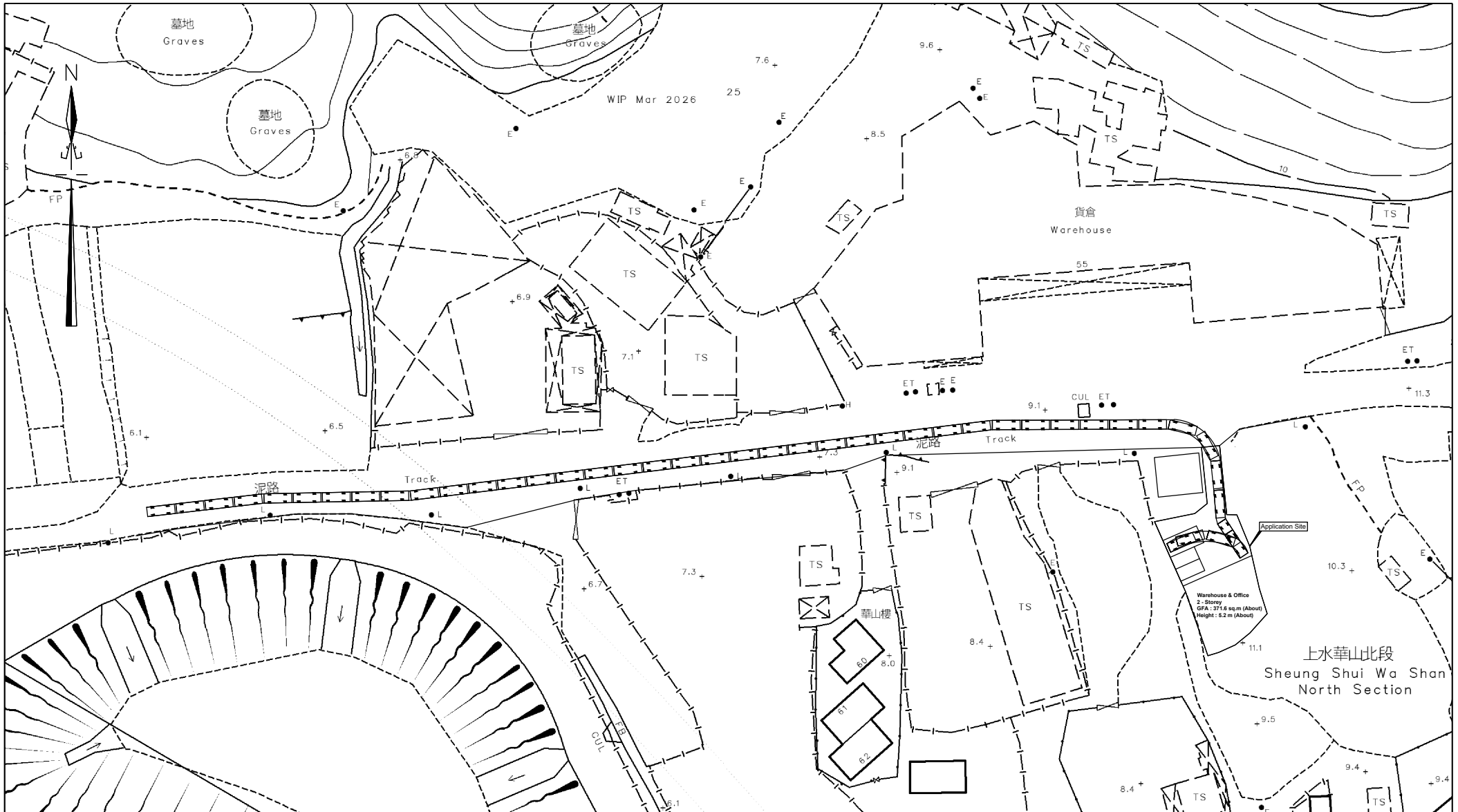

Project Title :
Proposed Temporary Warehouse for Storage of Construction Materials with Ancillary Office and for a period of 3 years

Drawing Title :
Routing Plan (D.D. 52 Lot No. 201 S.A, 201 RP & 202 RP (Part))

Scale :
1 : 1000

Date :
20-04-2026

Plan No. :
CW/DN/202/52/ROP1

Survey Sheet No. :
3-SW-2A

卓弘測量服務公司
CHUO WANG SURVEY SERVICES COMPANY

████████████████████
 ████████████████████
 ████████████████████



